

**marina reserve st. kilda**  
**detail design**

# marina reserve masterplan



MARINA RESERVE MASTERPLAN  
MASTERPLAN  
SCALE (A1): 1:500 DATE: JULY 2013

REF: 10302\_REV H



Key

- security lighting to complement promenade detail
- rubbish bin to complement promenade detail
- drinking fountain to complement promenade detail
- indigenous/native coastal grasses/shrubs

- existing tree/large shrub removed/relocated subject to existing condition/value (total approx 45)
- existing tree/retained subject to existing condition/value
- new trees to complement promenade detail (approx 110)
- coloured paving treatments

- open lawn area
- redeveloped car park (approx. 50 spaces)
- bicycle track - through/commuter traffic
- marina emergency exit
- intersection / hub / shared use space
- trafficable surface, lockable bollard entrance
- view points
- proposed toilet block

- weather station viewing area
- active recreation zone with terrace seating & viewing decks to complement promenade detail
- artwork
- picnic and play area
- shade (temporary light weight structure)
- bicycle parking
- raised pedestrian crossing

- SECTION A - play elements & bbq area
- SECTION B - pedestrian path & carpark
- SECTION C - St. Kilda Marina & pedestrian path
- VIEW D - indicative location of perspective view

# proposed upgrade site plan

- reshaped surface
- new pathway network
- new bike path
- reduced car parking
- new active recreation & skateable space
- large open lawn
- picnic & play area
- public toilet



# proposed upgrade re-shaped surface

- high point remains 1500mm above carpark
- moved south toward marina fence

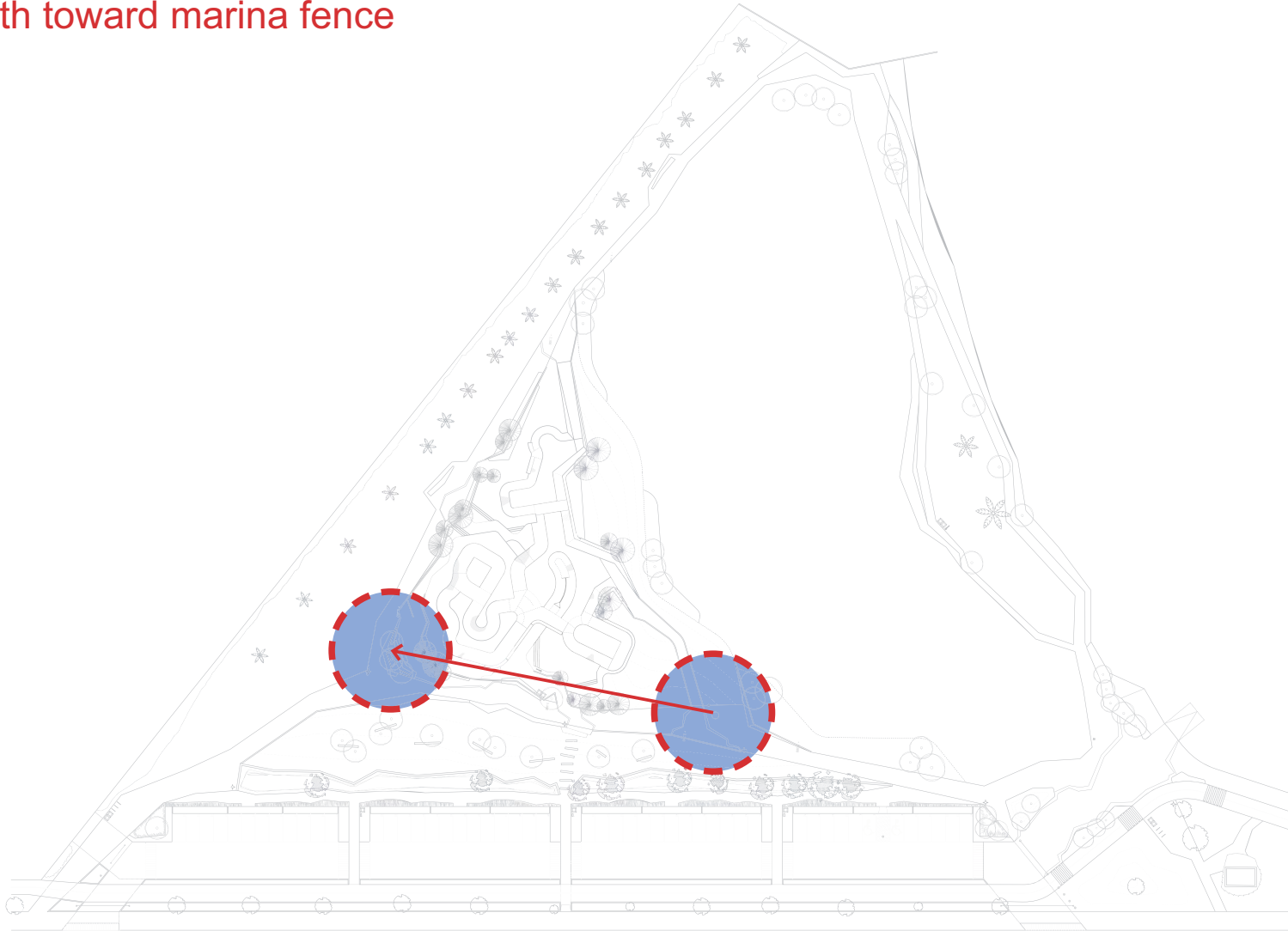

# proposed upgrade re-shaped surface

- high point remains 1500mm above carpark
- 3300mm above sea level
- creation of amphitheatre

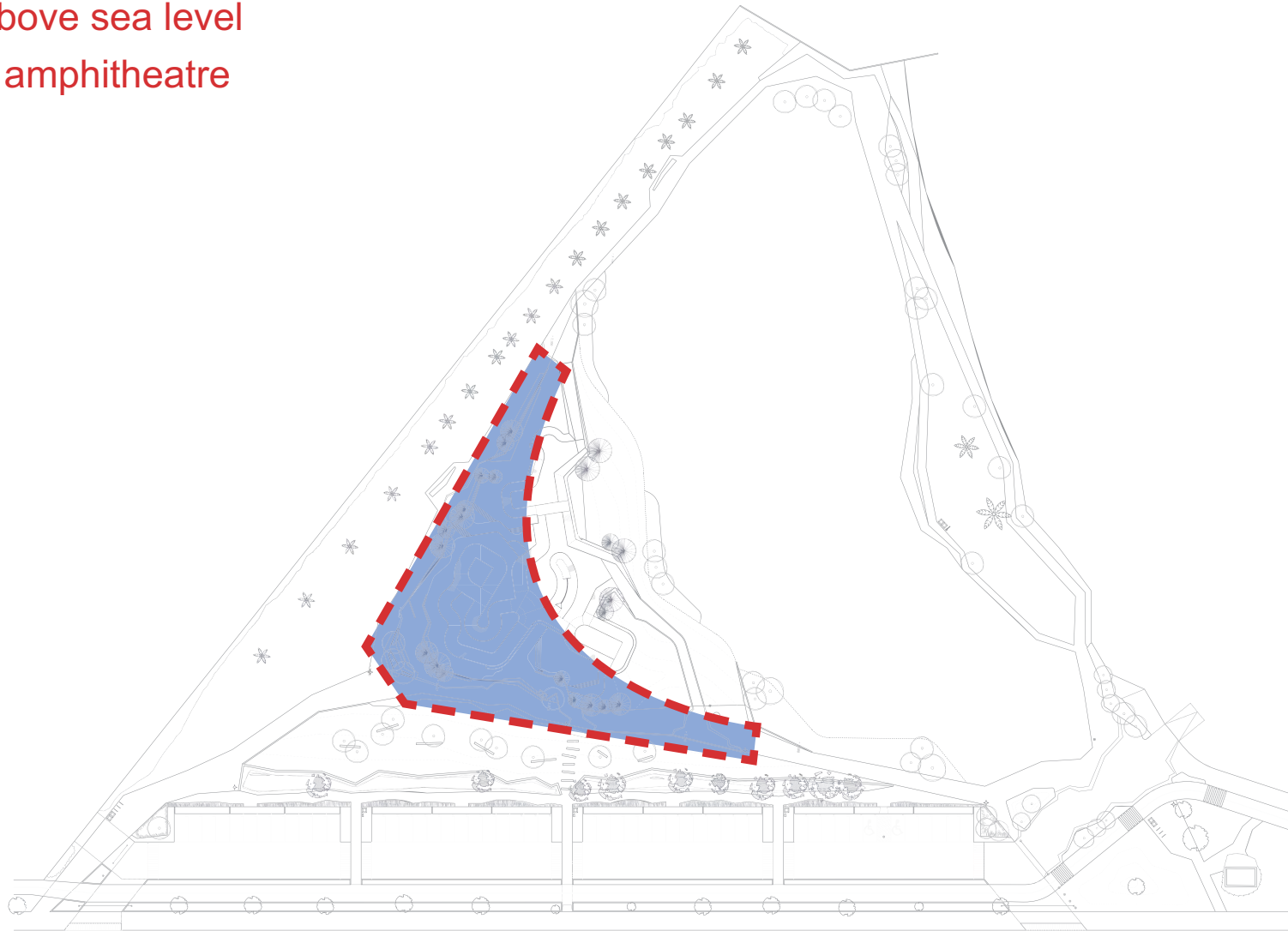

# proposed upgrade revised carpark

- spaces reduced from 120 to 50
- area reduced from 3000 m<sup>2</sup> to 1400m<sup>2</sup>
- 3 speed bumps / pedestrian crossings
- 2 DDA compliant disabled spaces
- lockable gates

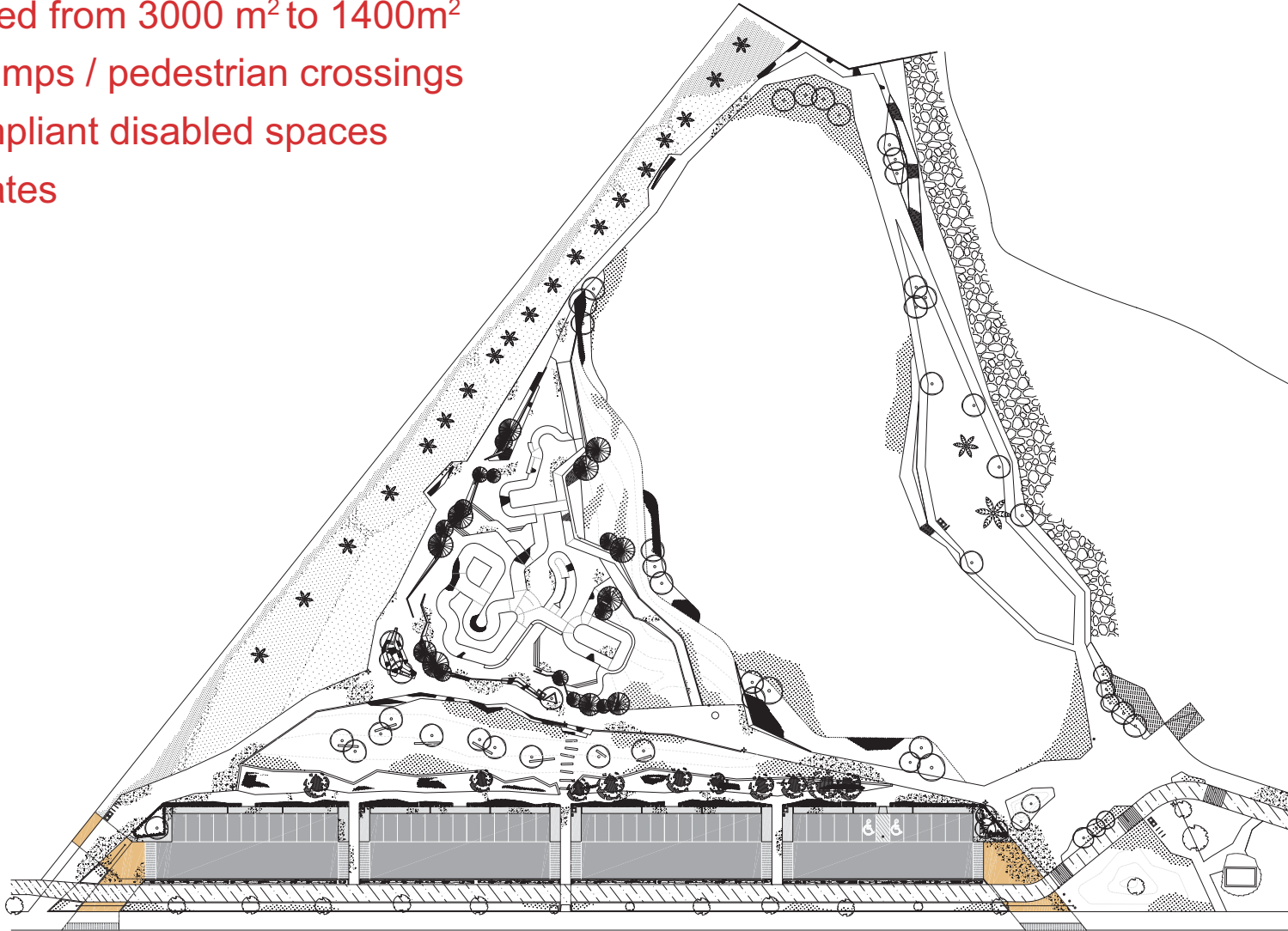

# proposed upgrade revised carpark

- car park entry from Marine Pde.
- emergency exit from marina carpark
- cross-over of bike path & existing footpath

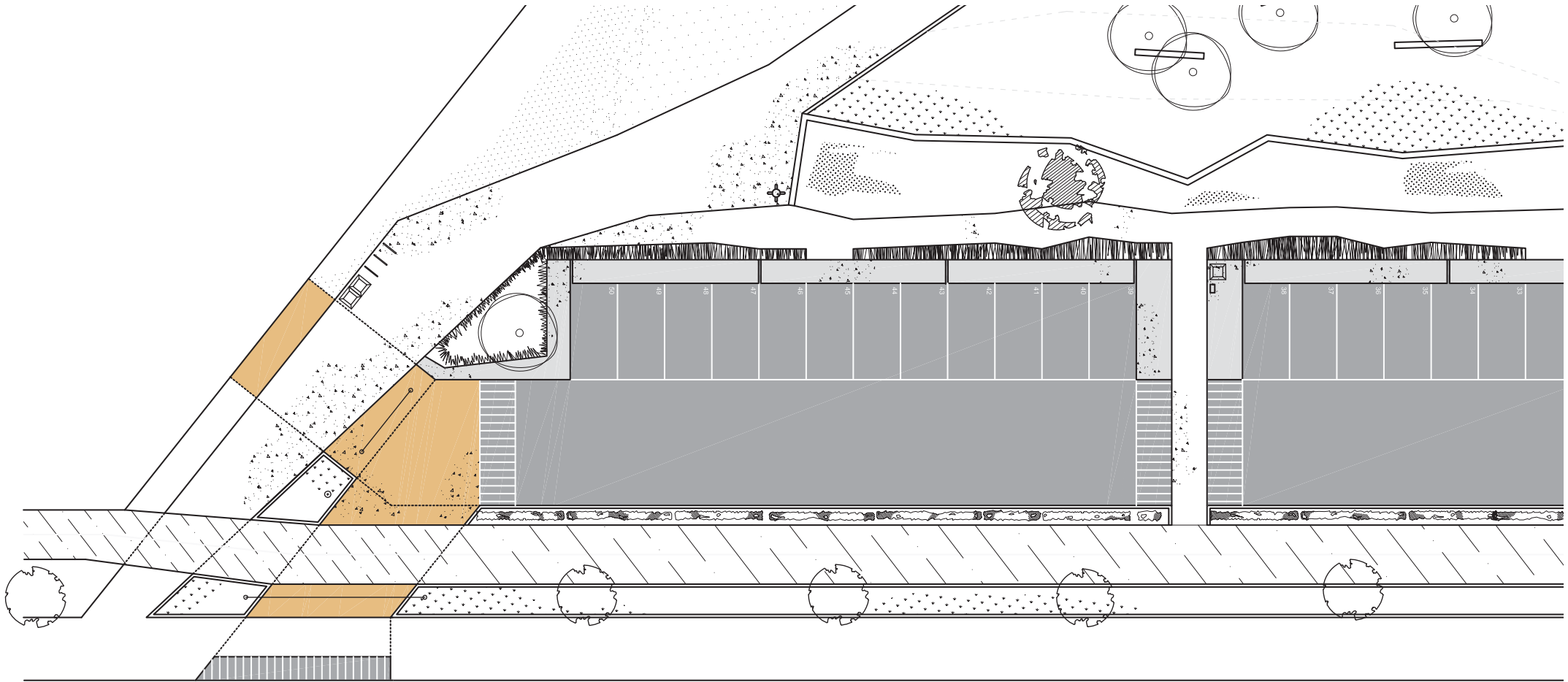

# proposed upgrade revised carpark

- carpark exit to marine
- cross-over of bike path & existing footpath
- access for reserve & beach maintenance vehicles

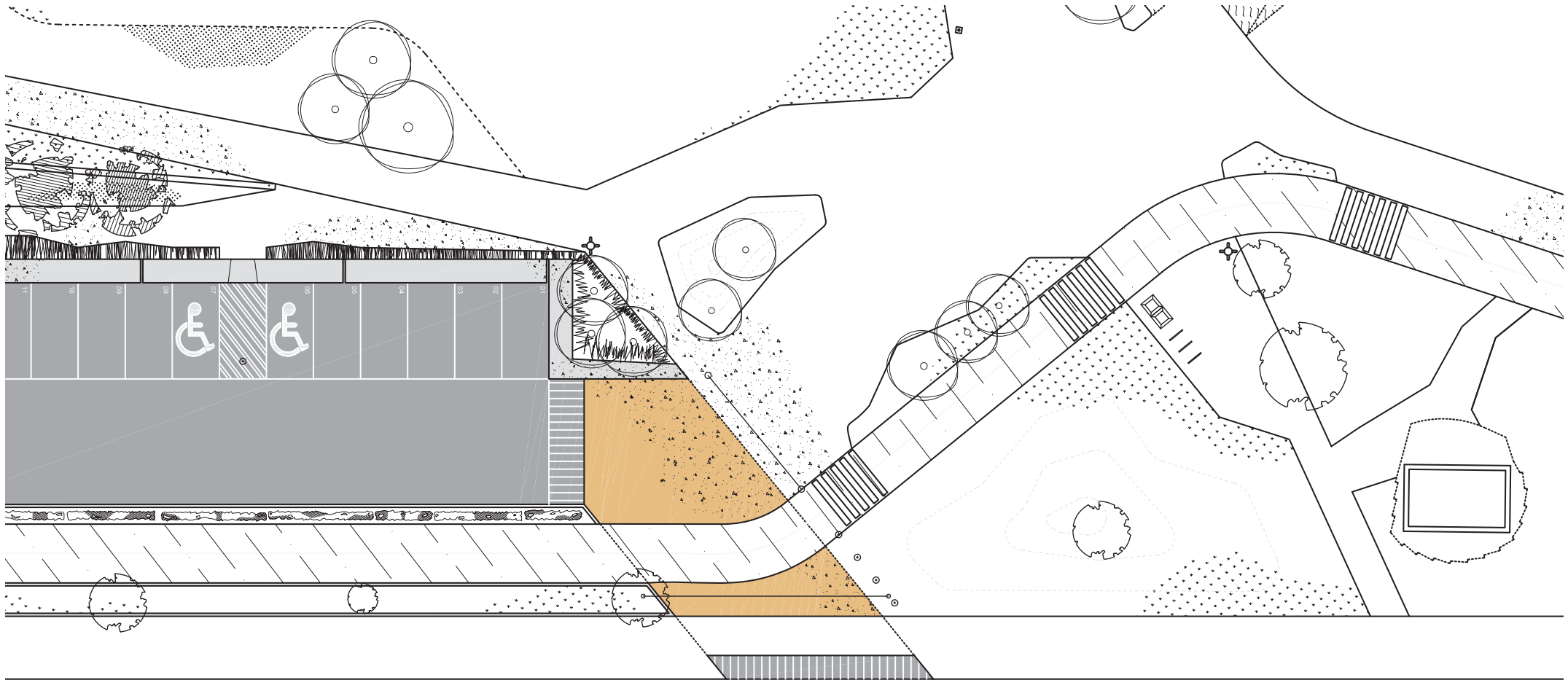

## proposed upgrade revised carpark

- edge kerb to carpark
- kerb, raingarden & retaining wall restrict vehicular access to site

