

Lyell Iffla Reserve

Consultation

City of Port Phillip conducted extensive engagement with the local community in August and September 2012. It included:

- two onsite consultations at the reserve
- discussions with children from Galilee Catholic Primary School
- consulting with children at storytime, Emerald Hill library
- online survey through City of Port Phillip's Have Your Say website

Feedback submitted to City of Port Phillip indicated the reserve is used by all ages in the community. The community has a great sense of ownership of the reserve and some example of the feedback about the reserve is below

"the reserve is our shared garden".

"I take a cup of tea with me from my house to the reserve where I sit and enjoy the sun"

"it is a little oasis"

"a good mix of trees, play area and play grounds"

"the native trees are home to many birds and provide fresh air and greenery so close to the city. The big gum trees are glorious"

"it is very poor looking right now"

"it's a tiny bit of green space in a densely populated suburb of highly stressed city workers"

For further information contact:

Stacey Robinson - email: ospace@portphillip.vic.gov.au or phone: 9209 6777



What we heard...

Below are key themes which the community discussed for Lyell Iffla Reserve

Trees area

The majority of respondents loved the trees area of the park with the trees and tanbark where kids and adults could explore and play with sticks. 'Tree cover on one side of the park is nice and quite unique when compared to other parks in the area' On the other side there were also some residents who disliked the leaf and tanbark litter which makes that area look untidy.

The trees area of the park was overall incredibly important to the community as it offers a different experience for users compared to other parks. As part of the design, the range of activities in this area has been increased to encourage further play in this zone.

Open space vs play space area

Community members expressed their preference for keeping the large open grass area, as this is a high use zone for ball games. There were also some requests for cricket, AFL and soccer goals.

Providing a range of spaces in the reserve is recognised by the City of Port Phillip. A large area of grass will remain and the newly planted trees 'in the way of the cricket' will be removed. The chin up bars will be strategically placed so can double use as goals.

Accessibility to the park

It was emphasised by people that the park is difficult to access across Dorcas St as there isn't a pedestrian refuge opposite the park. The lack of a pram crossing on Lyell St was also an improvement people raised.

There is a pedestrian crossing with lights available at Pickles St which is approx 70 metres at the closet point of the park..

Facilities updated

The community felt that the existing seating in the park was tired and in need of updating. In particular the timber slats that are wide enough for children's feet to fall through. There were requests for a BBQ in the park and discussions around the position if it was to be included in the design.

The City of Port Phillip is upgrading existing furniture in the new design. Lyell Iffla Reserve is defined as a local park and BBQ's are not suggested at this park size so it has not been included in this design.

Climbing, slides, equipment

A strong theme from the children coming through was their desire for climbing. The existing tree in the park was a favourite for children and the opportunity to climb on a natural element. Climbing was shown through their desire for ropes, climbing wall images, monkey bars, big slides - really tall ones were popular.

The two different large structures on the right offer opportunities for climbing with large slides as requested by the children consulted. We heard that children liked monkey bars and a rock river was also popular.

Fencing / Safety in the park

A number of community members felt that there was concerns with sightlines for cars passing near the reserve and the speed of the cars travelling. On the other side some community members felt that the reserve is 'safe for children and fenced from traffic'.

Informal planted barriers and a mixture of timber logs and rocks will help to define the boundary of the play area near Lyell St. The existing fences will remain in their current location. The safety of a child is the responsibility of the parent / carer. Fencing will not stop a child intent on escape. A full fence will not be considered as part of the concept.

New plantings / Growing area

There was some interest in having an area for growing food in the park. Also planting trees close together for climbing, planting along the fenceline, under planting the established trees were all ideas presented by the community.

The option of a community garden is discussed in more detail on the back of this brochure. City of Port Phillip is also considering adding fruit trees. There will be additional native trees and shrubs planted in the reserve to what is currently in the park.

Shade

The community expressed that the existing play area is often in the sun during the day and therefore it not used at these times of day.

The new playspace will incorporate areas in the sun and shade under the existing trees. Once the new trees grow there will be more shade again therefore a shade sail will not be included in the design.

Concept design...

Large structure options

SUBJECT TO FUNDING APPROVAL

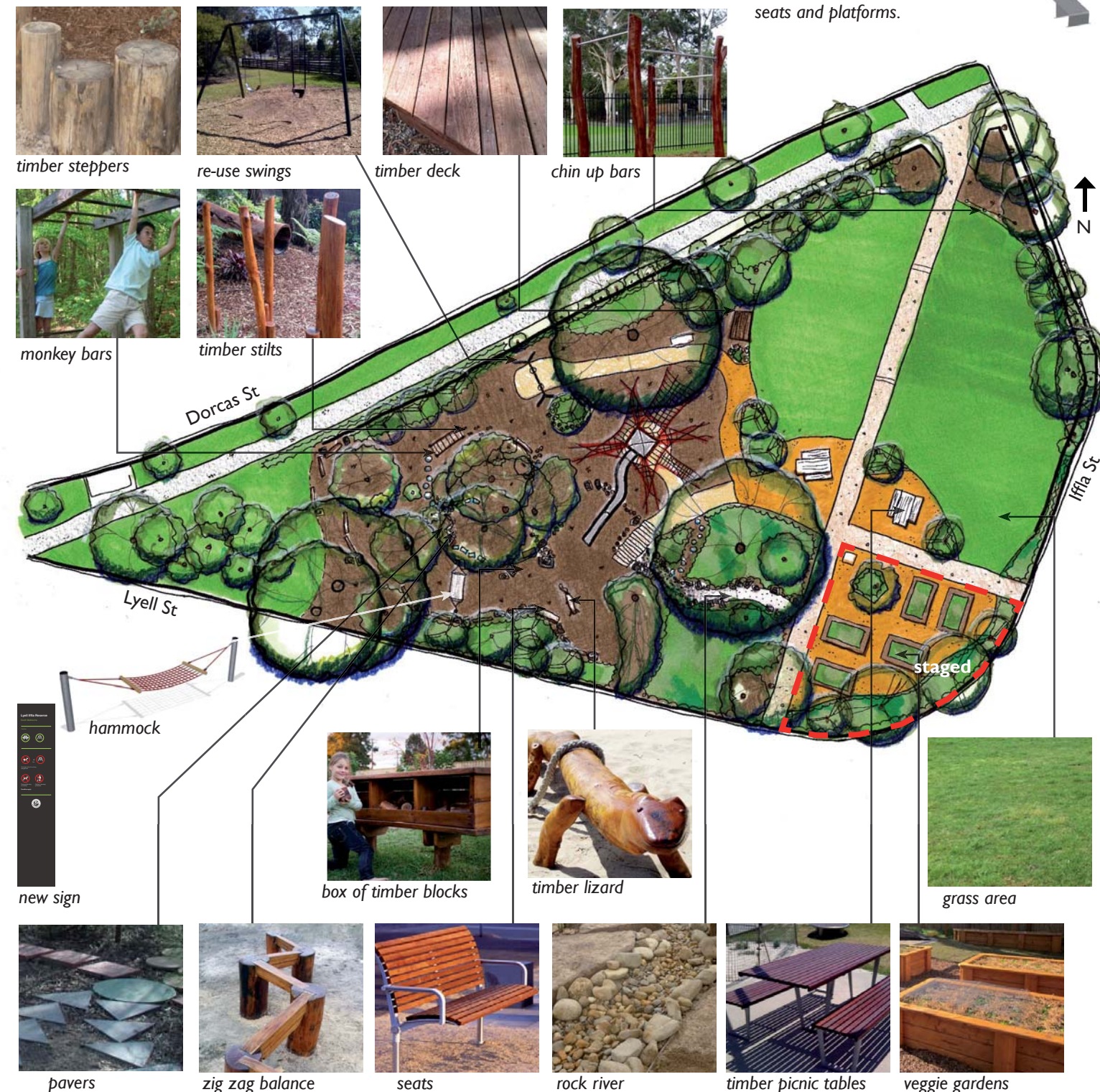
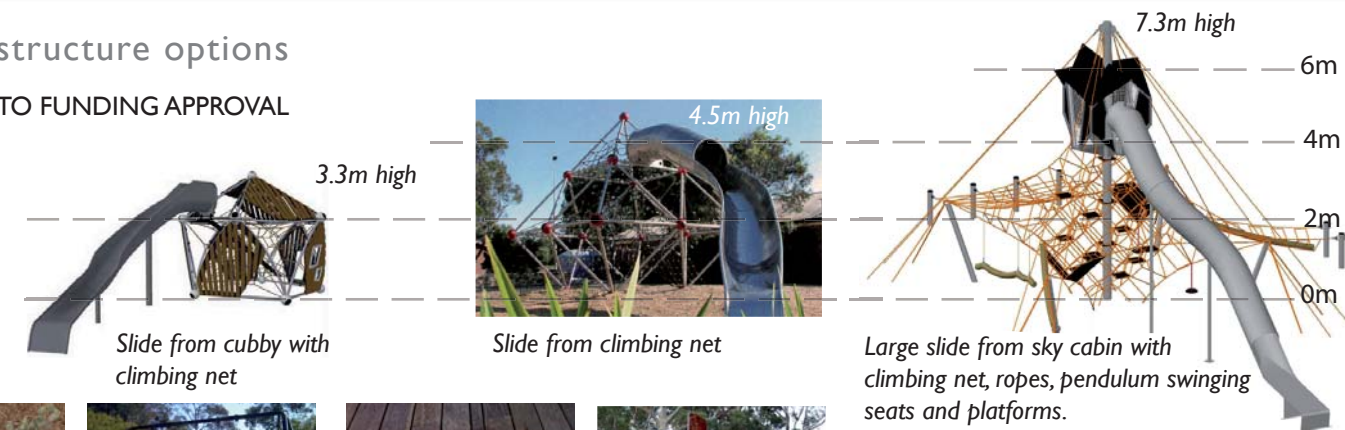

Next steps

Community garden at Lyell Iffla

Keen on greening Port Phillip?

Would you like to grow more fresh food to eat and share with your neighbours?

As part of greening Port Phillip, Council has developed a concept plan for a shared growing space at Lyell Iffla Reserve. Would you like to learn tips and techniques of composting, sustainability and the environment and get involved with your community?

This idea grew from initial consultations held in August / September 2012. Residents suggested it would be great to have some growing space in the reserve.

The current draft design is for 5 plots. Layout can be changed and bed types are still being considered. There will be no fence and the beds will be for sharing with others. Council want to hear from residents who are keen to be involved in the planning and maintenance of these gardens.

There is more information on the benefits of community gardens on City of Port Phillip's website: www.communitygardeningportphillip.net

Let us know if a community garden at Lyell Iffla Reserve interests you as it will need support to go ahead.

To **register your interest** contact Bianca Rayner

email: brayner@portphillip.vic.gov.au or

phone: 9209 6694



Feedback on the concept plan

Online

City of Port Phillip - Have your say website
haveyoursayatportphillip.net.au

On site consultation

Wednesday 13th March 2013 4-6pm

Email

ospace@portphillip.vic.gov.au

Phone

9209 6777

Staging of works / Budget

Council changed the works timeline for Lyell Iffla from what has previously been proposed.

The 2012/13 year Council staff will work only on the design for the reserve.

IMPLEMENTATION OF WORKS IS SUBJECT TO FUNDING APPROVAL

 Printed on 100%

Australian made recycled paper

