



## Part 3 of 4

### Emerald Hill Precinct Concept Masterplan

The Emerald Hill Precinct masterplan seeks to establish a range of multi-functional spaces within and around the South Melbourne Town Hall. Taking advantage of existing community, civic and arts functions within the area, the masterplan proposes a series of urban design improvements to draw pedestrians, provide local residents with adaptable public spaces and allow for a complementary activity to occur such as events, market stalls, exhibitions and others.

The overall masterplan concept is to reinstate a pedestrian focussed threshold around the Town Hall. Overtime, inactive building edges will be transformed to support street life and provide an engaging experience to the public realm.

The proposed urban design improvement projects will need to be staged (subject to existing Council commitments, funding, further consultation processes etc). However, there are a few key priority moves that could significantly transform the precinct in the shorter term including the upgrading of the Town Hall forecourt.





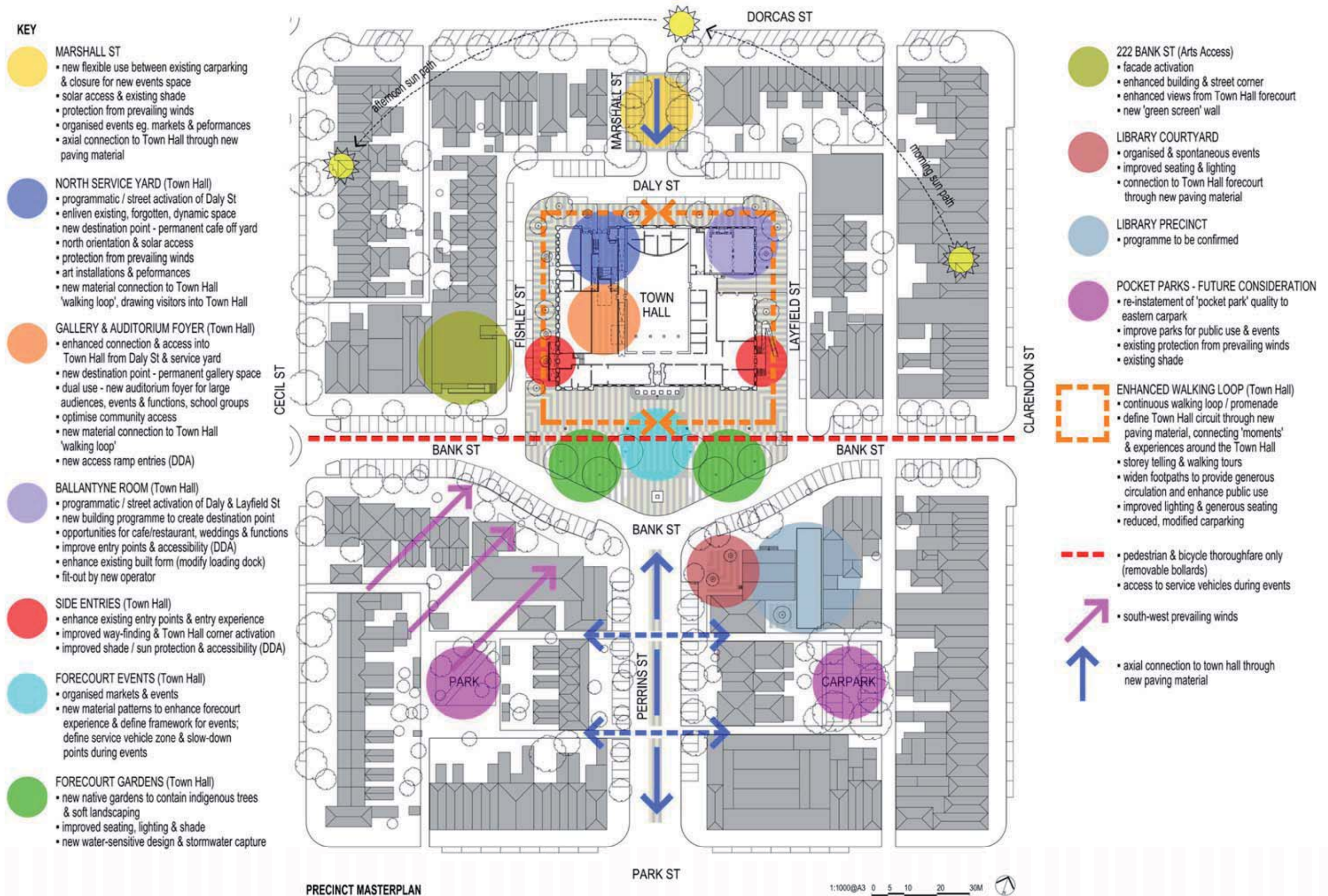



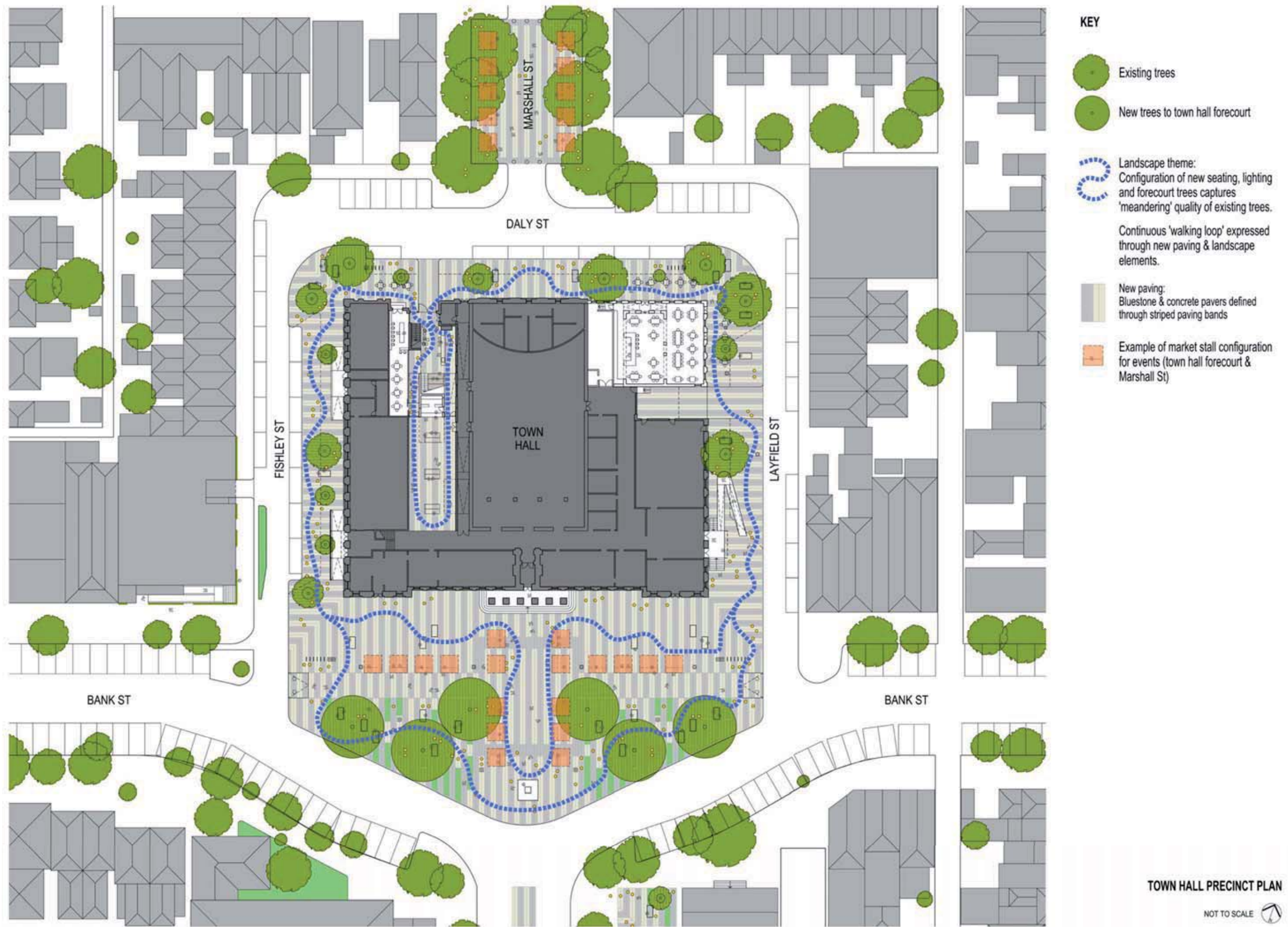



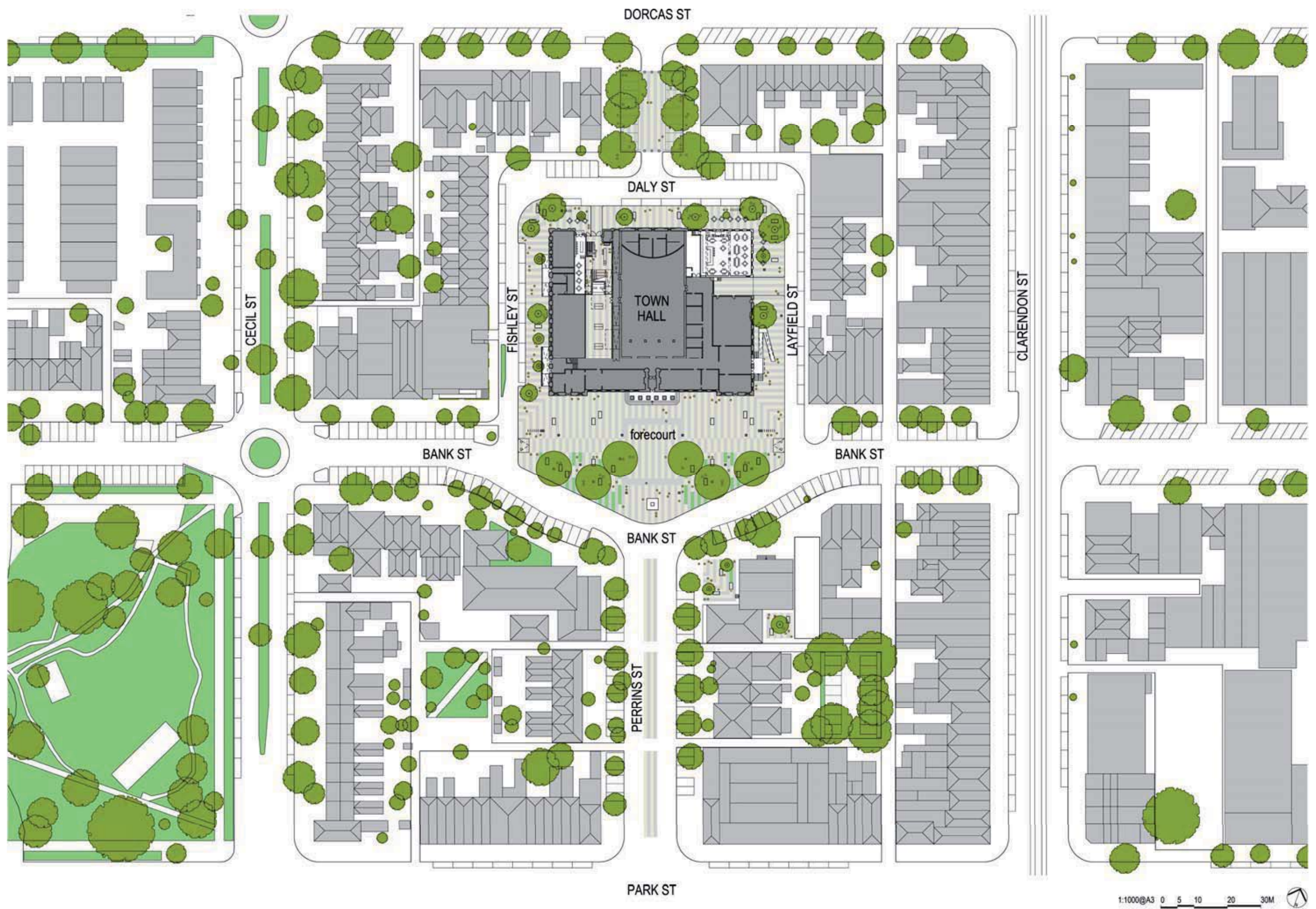



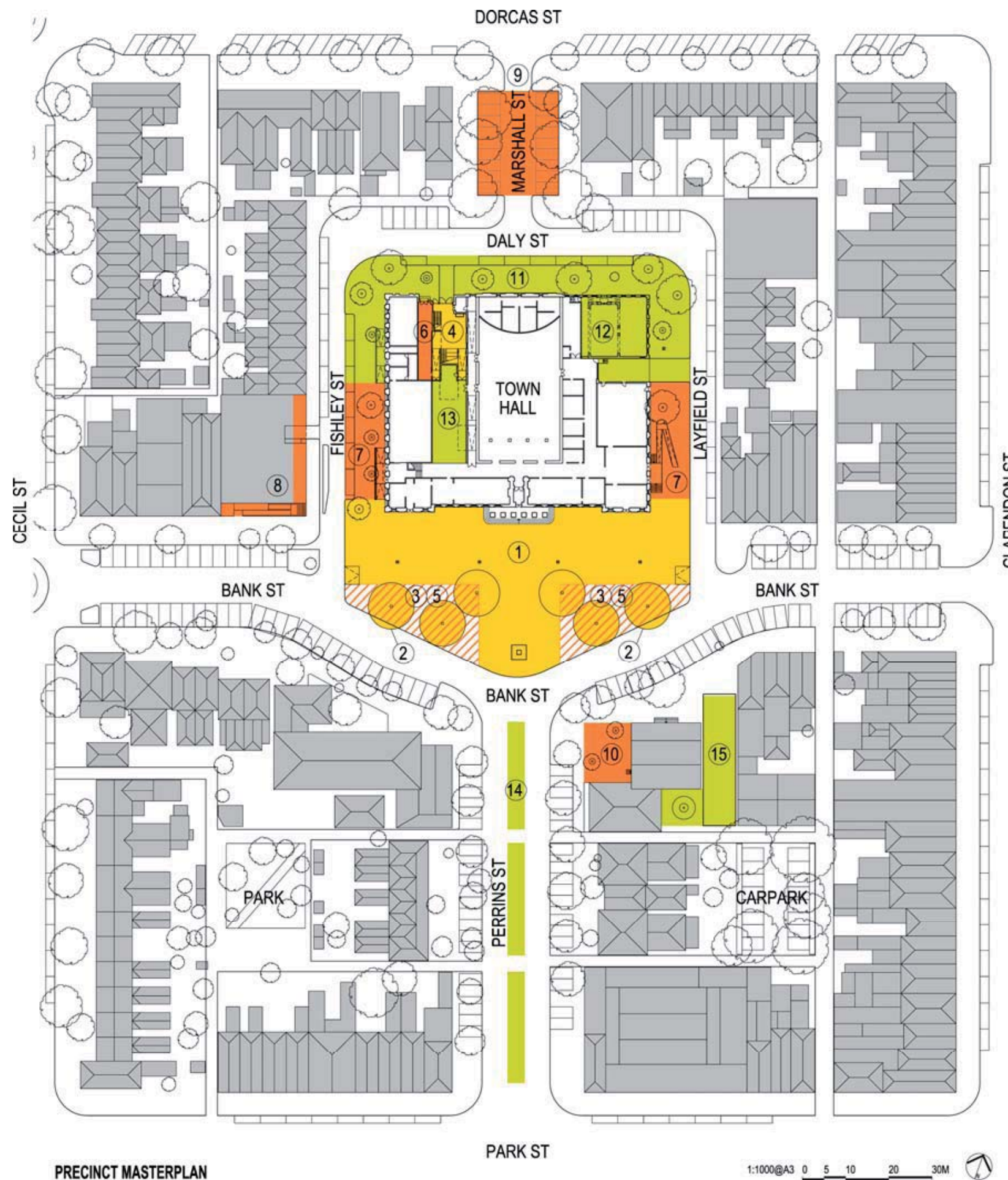

# KEY

## PRIORITY 1 - SHORT TERM

1. Forecourt - New paving & landscape works
2. Forecourt - New native trees
3. Forecourt - Temporary granitic sand to future native garden triangles
4. North service yard modifications

## PRIORITY 2 - MEDIUM TERM

5. Forecourt - Completion of new native garden triangles including paving, soft landscaping, lighting, seats, mist garden, & rainwater capture
6. New Cafe - Alterations to existing interior
7. Side entry modifications & pavement
8. 222 Bank St - New building facade
9. Marshall St - New landscape works
10. Library forecourt - New paving & landscape works

## PRIORITY 3 - LONG TERM

11. New paving & landscape works
12. Ballantyne Room - Programme to be confirmed
13. New gallery & auditorium foyer - Alterations to existing interior
14. New paving axis
15. Library precinct - Programme to be confirmed