



4b

Part 4 of 4

Detail Concepts

Marshall Street

The proposed Marshall Street improvements seeks to explore opportunities to use the existing car parking cell to the rear of Town Hall to be another flexible event zone. While the use and capacity for car parking will be maintained, the space could be closed (temporarily) with possibilities to hold pop-up markets, exhibitions and installations, musical performances etc.

Consistent paving treatments with the Town Hall forecourt are proposed and designed to establish a cohesive precinct character. Key axial views to the rear of the Town Hall will be maintained from Dorcas Street.





CONCEPT PLAN 1 - NEW LANDSCAPING:

- MAINTAIN EXISTING CARPARK WITH VEHICULAR THOROUGHFARE
- NEW PAVING AND UPLIGHTING TO PROVIDE AXIAL CONNECTION TO TOWN HALL 'WALKING LOOP'

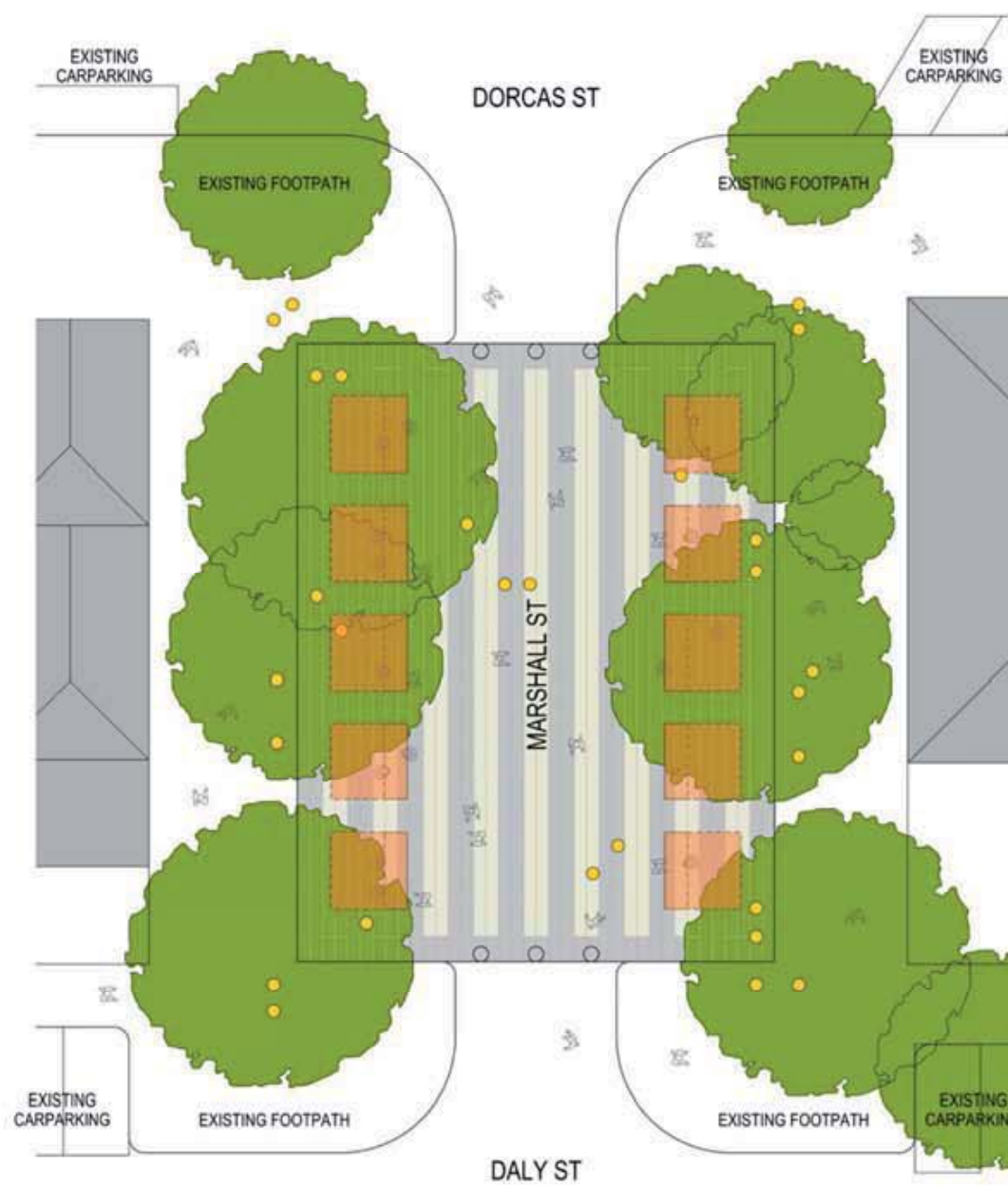

CONCEPT PLAN 2 - FLEXIBLE EVENT ZONE:

- CLOSURE OF MARSHALL ST FOR PEDESTRIAN ENTRY ONLY (NO VEHICULAR THOROUGHFARE), DEFINED BY NEW PAVING ZONE
- ORGANIZED EVENT ZONE WITH POSSIBILITIES FOR MARKETS, EXHIBITIONS & INSTALLATIONS, MUSICAL PERFORMANCES ETC.

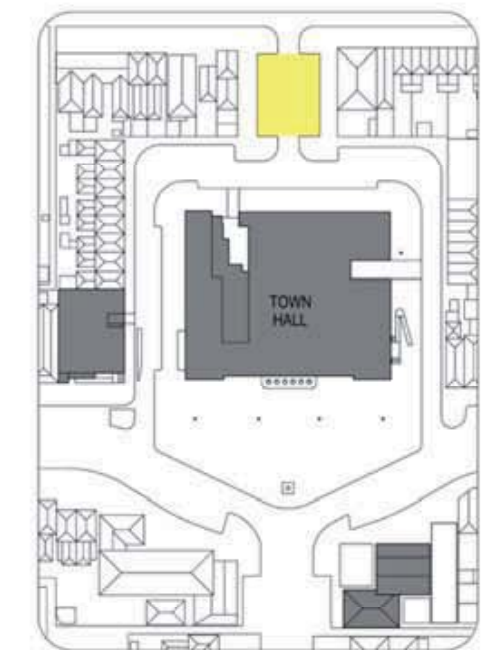

KEY PLAN

KEY

- Existing exotic trees
- New in-ground uplighting
- Removable stainless steel bollards
- Example of market stall configuration for events
- New bluestone & concrete pavers (striped paving bands)

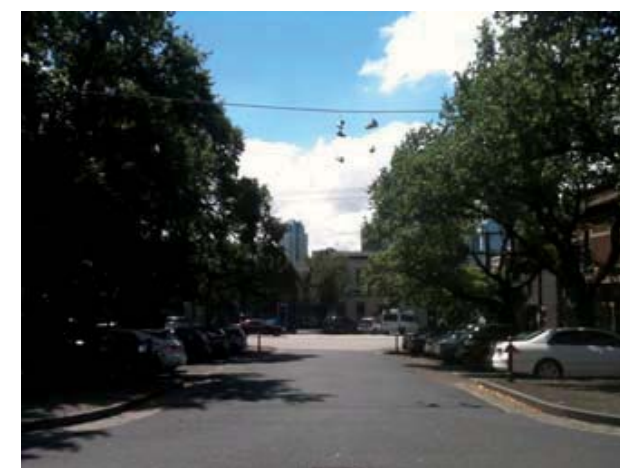

MARSHALL STREET – NEW LANDSCAPE WORKS



NORTH END - VIEW TO TOWN HALL / DALY ST FACADE



SOUTH END - VIEW TO TOWN HALL SERVICE YARD



SOUTH END - VIEW TO BALLANTYNE ROOM



MARSHALL & DALY STREETS - AERIAL VIEW