



**4f**

## **Part 4 of 4**

### **Detail Concepts**

#### **222 Bank Street**

222 Bank Street is located on the corner of Fishley and Bank Street, adjacent to the main facade of the Town Hall. The building is Council owned (previously used as Council offices) and has been recently let to exciting new arts tenants.

The existing building has undergone a number of modifications (latest extension circa 1980's) and is considered at odds with the prevailing neighbourhood character of Emerald Hill.

The proposed improvements include a 'green screen' to be the new face of the building. In line with Council's Greening Port Phillip Strategy, there is possibilities for a vertical garden to wrap the building form and establish an attractive backdrop to the Town Hall.





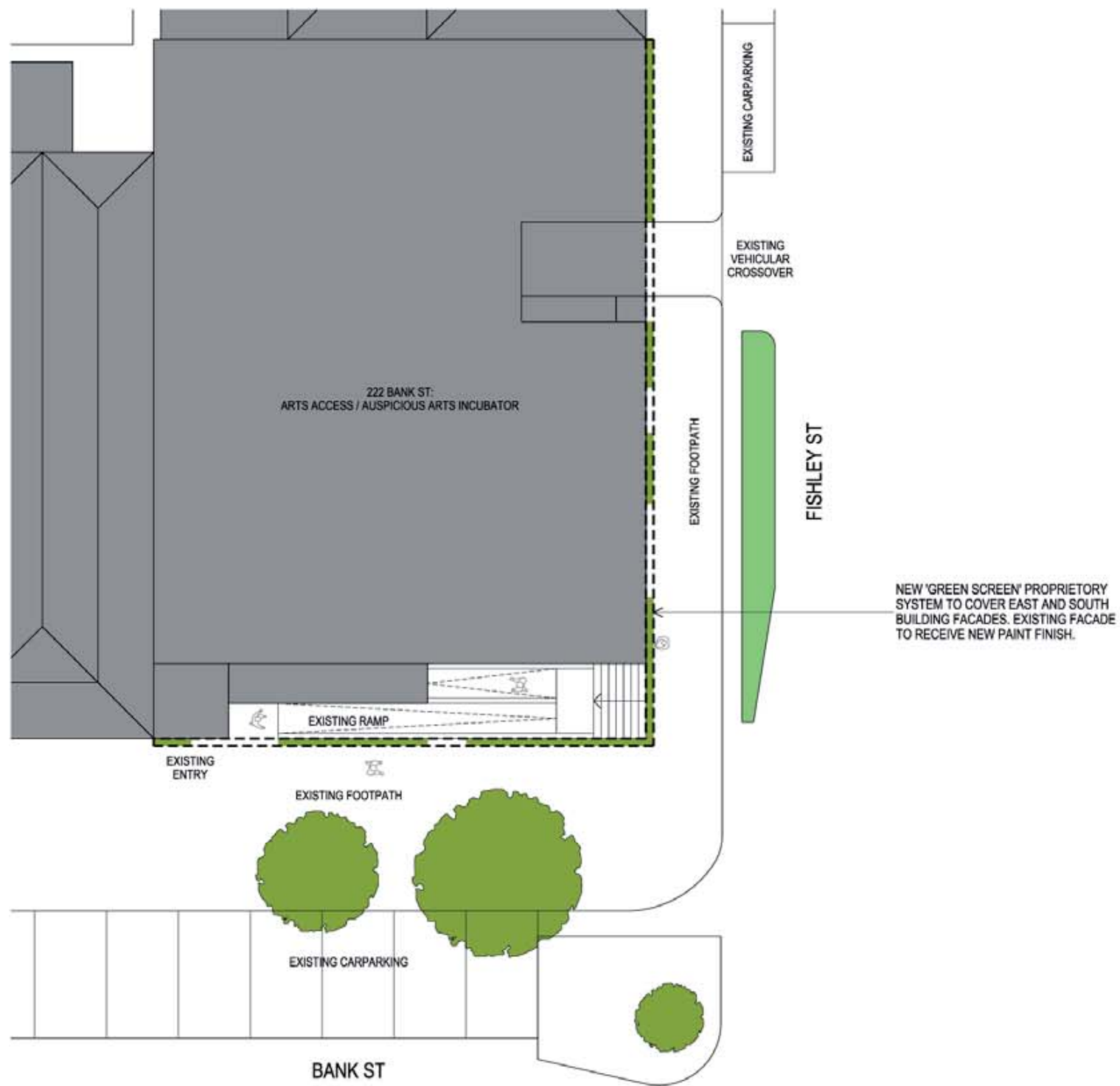

CONCEPT PLAN



222 BANK ST:  
NEW ACTIVATED FACADE AND STREET RELATIONSHIP

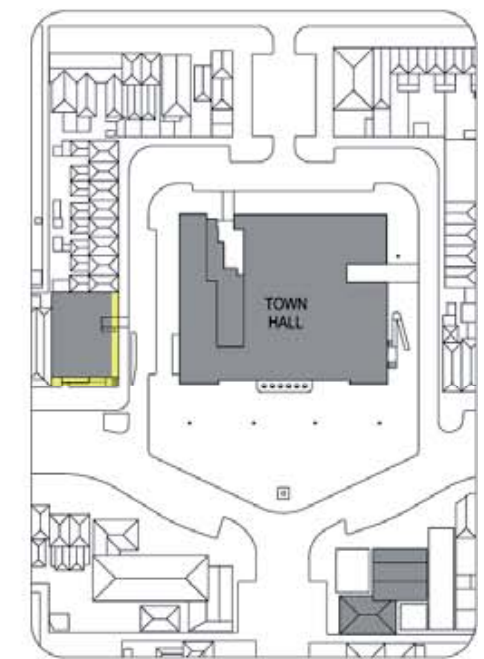

KEY PLAN







VIEW FROM TOWN HALL FORECOURT



VIEW FROM FISHLEY ST



CORNER ENTRY



VIEW FROM BANK ST