

Greeves Street

STREETSCAPE UPGRADE

Council is inviting community feedback on the proposed concept design to contribute to further development of the streetscape upgrade. You can submit feedback on the concept design by returning the enclosed form or by submitting feedback online at www.portphillip.vic.gov.au/haveyoursay

Background

As part of Council's ongoing streetscape improvement program, a streetscape renewal project for Greeves Street, St Kilda, is scheduled for construction by the end of 2012. A proposed concept design for the streetscape has now been developed and Council is keen to hear feedback from the community.

The Greeves Street Streetscape Upgrade concept design aims to improve the local environment for all who live in, work in and visit St Kilda, and responds to key amenity and safety concerns that have been associated with this particular site. Concerns raised by residents, including litter, syringe disposal, lighting and safety, drainage, and aesthetics within the streetscape, have been addressed in the proposed concept design.

Consultation to date

Workshops and meetings with residents and key stakeholder groups, including Victoria Police, have helped inform the proposed design.

Proposed design

In addition to several steps taken so far to address amenity and safety concerns, the concept design proposes the following:

Lighting and safety

- Pruning some tree canopies and removing trees in front of No. 3 and No. 5 to reduce the number of 'dark spots' along the street, allowing more light to reach the footpaths and reducing light obstruction caused by dense tree canopies.
- Incorporating lighting into existing garden beds and within feature trees.
- Incorporating wayfinding features at 8-15 m intervals along the footpath to help guide people safely along the street.

Drainage

- Appropriate drainage solutions that may result in the redesign and construction of traffic islands, inclusion of new pits and pipes, and realignment of the bluestone kerb and channel in certain sections of Greeves Street.

Landscaping

- Appropriate landscaping materials for garden beds to avoid runoff onto the road pavement.
- Selecting plants that are drought-tolerant, require minimum maintenance and whose foliage will not clog litter traps.
- Regular maintenance to ensure plants are well established and any damaged plants are quickly replaced.

Litter

- Additional rubbish bins, as well as two new syringe bins to promote appropriate disposal of syringes.

Parking restrictions

- Parking restrictions will remain unchanged. Residents can apply in writing for changes as of February 2012 by contacting Council's Traffic and Parking Design Department on 9209 6132.

GREEVES STREET

INKERMAN STREET

BLANCHE STREET

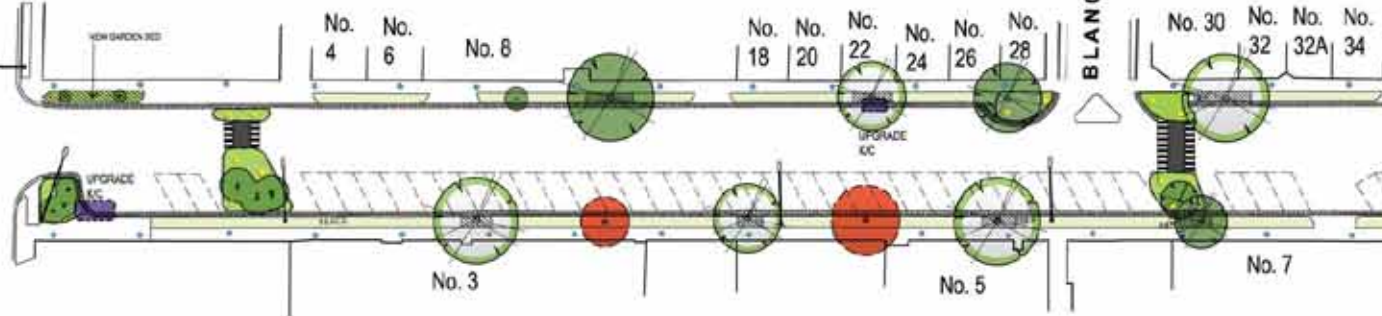

LEGEND

- EXISTING TREE TO BE RETAINED
- EXISTING TREE TO BE RETAINED AND CANOPY THINNED
- EXISTING TREE PROPOSED FOR REMOVAL
- NATURE STRIP GARDEN BEDS, GENERALLY UNDER TREES
- EXISTING GRASSED NATURE STRIP TO BE RETAINED WITH AREAS FOR RUBBISH BIN PLACEMENT TO BE PROVIDED
- EXISTING GARDEN BED TO BE REPLANTED
- EXISTING ANGLED PARKING BAYS TO REMAIN
- EXISTING STREET LIGHT

UPGRADE K/C
SECTION OF EXISTING BLUESTONE KERB AND CHANNEL TO BE RESET TO ALLEVIATE FLOODING

EXISTING SPEED HUMP BRICKWORK TO BE REMOVED AND REPLACED AND LINEMARKING TO BE UPGRADED

DRAINAGE IN THIS AREA CURRENTLY BEING ASSESSED TO DETERMINE SPECIFIC IMPROVEMENTS TO THE DRAINAGE INFRASTRUCTURE

EXISTING AREA PRONE TO FREQUENT AND SIGNIFICANT FLOODING

PROPOSED WAYFINDING PATTERNS

PROPOSED FEATURE LIGHTING WITHIN GARDEN BEDS- COMBINATION OF SCULPTURAL PIECES WITH LIGHTING, ROCKS WITH EMBEDDED LIGHT OR LOW TIMBER LIGHTS

Feature lighting within trees

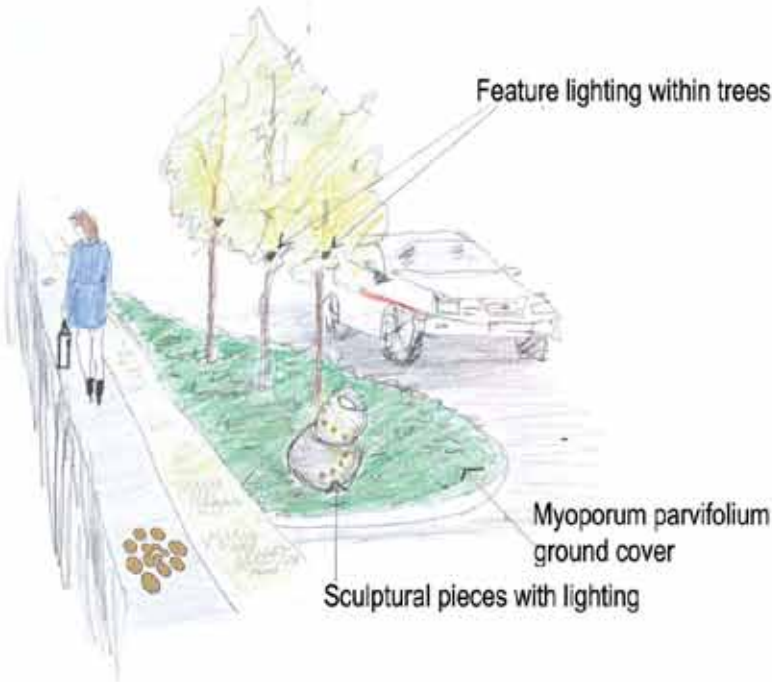

PROPOSED PLANT SELECTIONS

The existing planting within garden beds will be removed and replaced with a variety of hardy plants below.



"Baby sunrose"
Aptenia cordifolia



Grevillea "Royal Mantle"



"Orange pigface"
Lampranthus aurantiacus



"Dwarf cushion bush"
Leucophytia brownii



"Creeping boobialla"
Myoporum parvifolium



"Stonecrop"
Sedum



"Round leaf pigface"
Disphyma crassifolium



"Tree aeonium"
Aeonium arboreum



Echeveria



"Common everlasting daisy"
Chryscephalum apiculatum

STREETSCAPE UPGRADE- CONCEPT DESIGN

VALE STREET

CARLISLE STREET

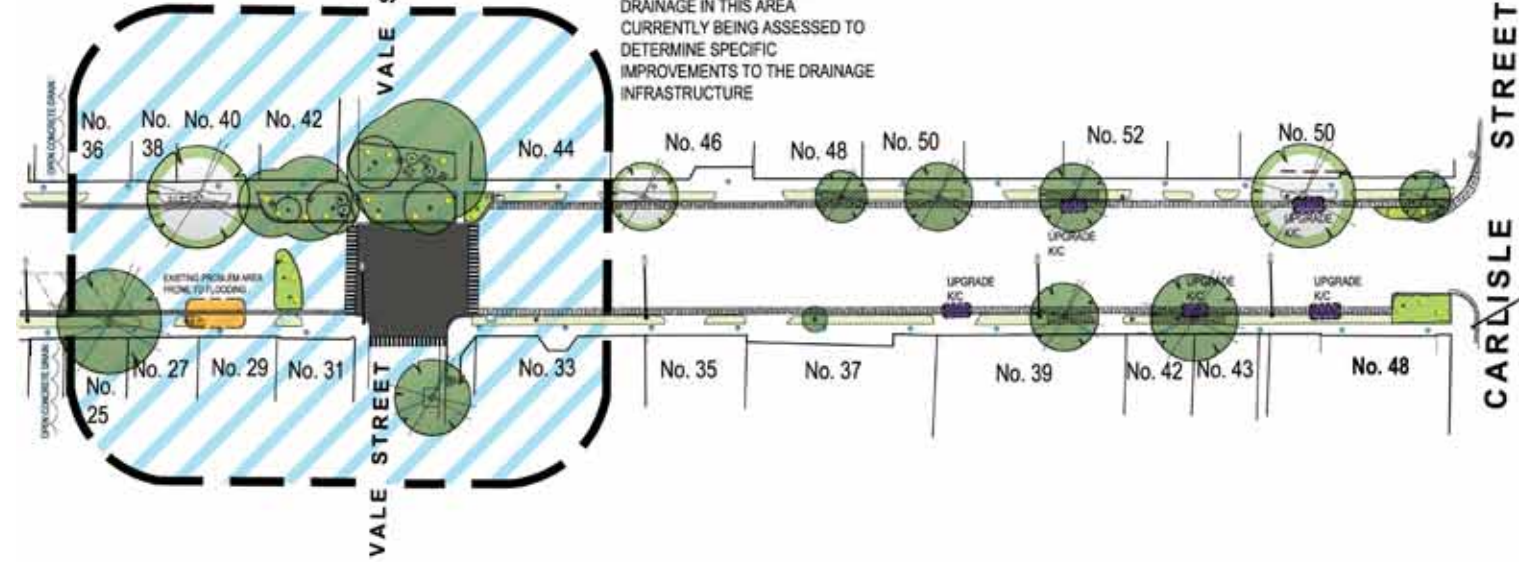

PROPOSED LIGHTING SELECTIONS

Timber/concrete low lights



Combination of uplighting within feature trees and low level lighting



Pruning of some tree canopies to improve lighting

Low timber posts with side lighting

Wayfinding features within existing footpath

PROPOSED WAYFINDING FEATURES

Wayfinding features will be embedded in existing footpaths at 8-15m intervals.



Have your say

You can submit feedback on the Greeves Street Streetscape Upgrade concept design by returning the enclosed feedback form in the reply paid envelope provided or by submitting your feedback online at www.portphillip.vic.gov.au/haveyoursay

The proposed concept design is also available to view online.

Information session

An information session will be held at 6 pm on Monday 6 February 2012 at the St Kilda Town Hall, to give the community an opportunity to hear more about the project and provide feedback.

For more information about this session or to RSVP contact Lee Pressick, Project Manager at lpresic@portphillip.vic.gov.au or by phone on 9209 6387 by Thursday 2 February 2012.

Please advise if you have any hearing, access or interpretation requirements.

Consultation on the concept design closes Monday 13 February 2012.

What will happen next?

- Feedback from the community on the proposed design will be presented to Council. A decision will then be made on how to progress this project.
- The detailed design and construction will be finalised in accordance with Council's decision.
- Greeves Street residents will be notified of the outcome and construction timelines.

For more information, please contact Lee Pressick, Project Manager at lpresic@portphillip.vic.gov.au or phone 9209 6387. You can also visit the Greeves Street Streetscape Upgrade project page at www.portphillip.vic.gov.au/greeves-st-upgrade.htm for regular updates.

